



# PRODUCT BULLETIN #483

## NEW DEXTER FORTRESS™ BOLT-ON AND THREADED ALUMINUM OIL CAPS

September 19, 2023

Dexter is pleased to announce Fortress, a complete line of aluminum oil caps. Backed by over 60 years of known and trusted technology, the new caps have been designed and engineered by Dexter as a bona fide, superior bearing protection solution for 7,000 - 16,000 lbs. axle capacities. With durability in every detail and backed by Dexter's 5-year warranty, you can hit the road knowing your equipment is fortified with next-level bearing protection.

The new **Fortress bolt-on cap** is a revolutionary new product for 9,000 - 12,000 lbs. axle capacities, similar to those on heavy-duty trucks and trailers. This bolt-on style hub and cap is a natural evolution in medium-duty axles, as most trailers using these axles are built for commercial use and demand superior performance.

Additionally, a line of **Fortress threaded caps** will be available in axle production and aftermarket kits for threaded hubs. These caps will be available for 7,000 - 16,000 lbs. axle capacities.

### » FORTRESS™ BOLT-ON CAP

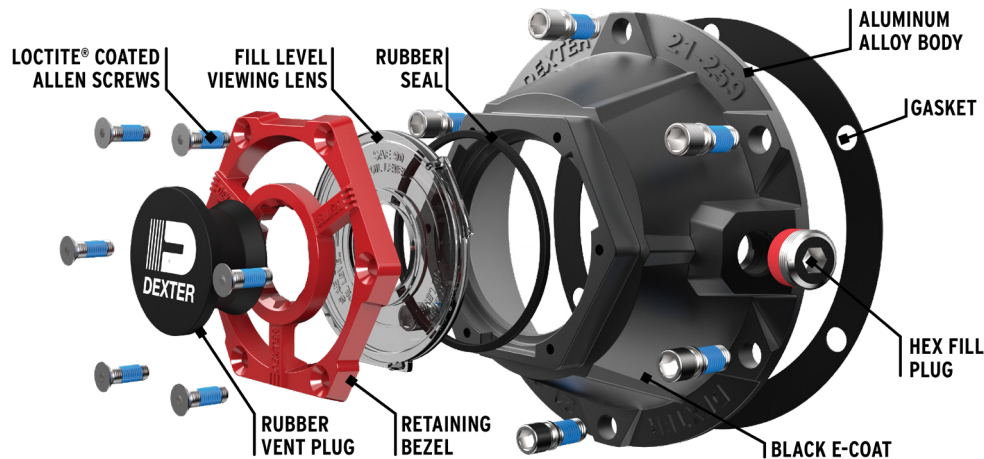

### » FORTRESS™ THREADED CAP

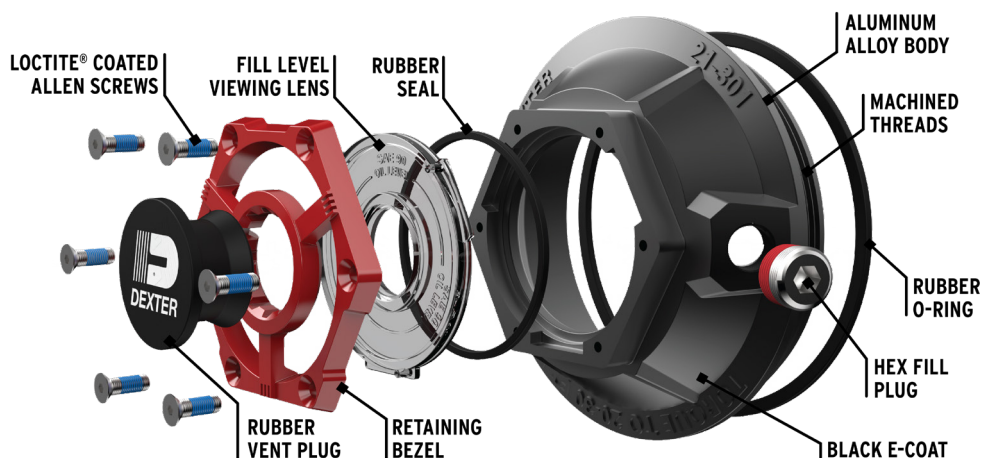

#### FEATURES AND BENEFITS

- The reinforced retainer ring design shields against damage and protects the fill level viewing lens.
- Pre-applied Loctite® coating on mounting bolts and side-fill plug.
- Cast aluminum body with a black matte finish for exceptional durability and impact resistance.
- Larger, easily accessible side fill or drain plug.
- The rubber center plug, uniquely designed to fit the Dexter Fortress cap, is engineered and tested to ensure proper pressure relief.
- Torque values located conveniently on outside rim of cap.
- Transparent fill level viewing lens allows for quick visual check of oil level.

## AXLE PRODUCTION

The Fortress Aluminum Oil Cap will be available for all 7,000 - 16,000 lbs. axle capacities to ship mid-October. Please reference the chart below for specific capacity and model breakdowns.

AXLE CAPACITY	CAP STYLE	AXLE MODELS
7,000 - 8,000 lbs.	THREADED	#11, #12, #12T, #12V, #13, #13N, #13T, D52, D60, D70, D72, D80, D80N
9,000 - 12,000 lbs.	BOLT-ON	#13G, #13D, #14, #14T, D90, D100G, D100, D120
15,000 - 16,000 lbs.	THREADED	D150 and D160

## HUBS WITH BOLT-ON CAPS

Dexter has redesigned the 9,000-12,000 lbs. hubs series with an improved Fortress Bolt-On style cap. These hubs will have new part numbers, as listed below. Dexter will continue to sell the previous thread in hub part number for service parts. Hubs with thread in caps will not change and will continue to use existing part numbers.

NEW HUB P/N	OLD HUB P/N	NEW HUB DESCRIPTION
008-288-13	008-288-03	9K-10K GD HUB, 8 ON 6.5", CUPPED & STUDDERED, BOLT-ON CAP
008-288-15	008-288-05	9K-10K GD HUB & DRUM, 8 ON 6.5", CUPPED & STUDDERED, BOLT-ON CAP
008-288-16	008-288-06	9K-10K GD HUB, 8 ON 6.5", CUPPED & STUDDERED, ABS, BOLT-ON CAP
008-288-17	008-288-07	9K-10K GD HUB, 8 ON 6.5" CUPPED & STUDDERED, ROTOR, BOLT-ON CAP
008-288-18	008-288-08	9K-10K GD HUB & ROTOR, 8 ON 6.5", CUPPED & STUDDERED, ROTOR, BOLT-ON CAP
008-430-13	008-430-03	10K GD HUB, CUPPED & STUDDERED, BOLT-ON CAP
008-430-15	008-430-05	10K GD HUB & DRUM, CUPPED & STUDDERED, BOLT-ON CAP
008-430-17	008-430-07	10K GD HUB & DRUM, CUPPED & STUDDERED, ABS, BOLT-ON CAP
008-214-22	008-214-02	10K HD HUB & DRUM, 8 ON 6.5", CUPPED & STUDDERED, BOLT-ON CAP
008-214-25	008-214-05	10K HD HUB, 8 ON 6.5", CUPPED & STUDDERED, BOLT-ON CAP
008-214-26	008-214-06	10K HD HUB, 8 ON 6.5", CUPPED & STUDDERED, HI-PROFILE, ROTOR, BOLT-ON CAP
008-214-31	008-214-11	10K HD HUB & ROTOR, 8 ON 6.5", CUPPED & STUDDERED, BOLT-ON CAP
008-214-35	008-214-15	10K HD HUB & DRUM, 8 ON 6.5", CUPPED & STUDDERED, HI-PROFILE, ABS, BOLT-ON CAP
008-214-37	008-214-17	10K HD HUB & ROTOR, 8 ON 6.5", CUPPED & STUDDERED, ABS, WITH BOLT-ON CAP
008-214-28	008-214-08	12K HUB, 8 on 6.5", CUPPED & STUDDERED, HI-PROFILE, BOLT-ON CAP
008-214-29	008-214-09	12K HUB & DRUM, 8 ON 6.5" CUPPED & STUDDERED, HI-PROFILE, BOLT-ON CAP
008-214-30	008-214-10	12K HUB, 8 ON 6.5", CUPPED & STUDDERED, HI-PROFILE, ROTOR, BOLT-ON CAP
008-214-32	008-214-12	12K HUB & ROTOR, 8 ON 6.5" CUPPED & STUDDERED, HI-PROFILE, BOLT-ON CAP
008-214-36	008-214-16	12K HUB & DRUM, 8 ON 6.5", HI-PROFILE, ABS, BOLT-ON CAP
008-214-38	008-214-18	12K HD HUB & ROTOR, 8 ON 6.5" CUPPED & STUDDERED, ABS, BOLT-ON CAP
008-422-13	008-422-03	12K HUB, CUPPED & STUDDERED, FOR DRUM, BOLT-ON CAP
008-422-14	008-422-04	12K HUB, CUPPED & STUDDERED, FOR ROTOR, BOLT-ON CAP
008-422-15	008-422-05	12K HUB & DRUM, CUPPED & STUDDERED, BOLT-ON CAP
008-422-16	008-422-06	12K HUB & ROTOR, CUPPED & STUDDERED, BOLT-ON CAP

## THREADED CAP AFTERMARKET KITS

Threaded aftermarket kits will also be offered as outlined in the chart below.

KIT	K21-303-00	K21-302-00	K21-301-00	K21-304-00	K21-305-00
Capacity	5,200-8,000 lbs.	9,000 - 10,000 GD lbs.	10,000 HD - 15,000 lbs.	10,000-16,000 lbs.	10,000-16,000 lbs.
Dexter	K71-038-00, 021-035-00, K21-297-00	K71-704-00, 021-088-00, K21-257-00	K71-148-00, 021-036-00, K21-256-00	K71-859-00, 021-219-00, 021-229-00, K21-226-00	K21-298-00
AL-KO	-----	-----	-----	568220, K568220	-----
Rockwell	8001	-----	-----	12001	-----
Valcrum	ST-2875-AM	ST-350-AM	ST-400D-AM	ST-375-AM	ST-400L-AM
Lippert	695814	-----	-----	-----	693935

For more information and a product video visit [www.dexteraxle.com/fortress](http://www.dexteraxle.com/fortress).

Please contact your Dexter account manager for additional information and further assistance.



Matt Brady  
Product Manager