

Date: December 6, 2019

## Subject: Self Adjust and Manual Adjuster Screw Assembly to Utilize Compression Spring

Dexter is pleased to announce a change to the brake adjuster assembly used in both manual and Nev-R-Adjust® 10" x 2-1/4" and 12" x 2" electric brakes. The change adds a compression spring to the existing adjuster assembly. The new spring will provide an increased level of reliability and service life, while being housed inside the existing screw assembly.

The additional compression spring will be a running change that will be seen on product produced on or after December 2019. Ongoing sprung and Torflex® axles, kits, and replacement parts will include the new brake adjuster and will retain the same part number, requiring no changes in ordering.

Three screw adjusters that will integrate this new feature are the Self Adjust screw (LH part number 048-022-00 and RH part number 048-023-00) and the Manual Adjust screw (part number 043-004-00).

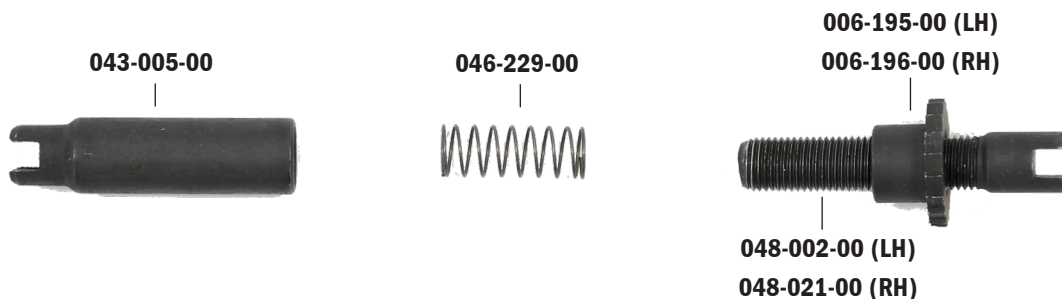

Nev-R-Adjust left hand screw assembly pictured above (part number 048-022-00) shown with new compression spring part number 046-229-00. The compression spring will remain hidden when assembled.

The improved adjuster screw shares exact measurements and size with the existing adjuster screw models. Therefore, it is completely compatible with existing brakes and will work as a replacement part on current brakes. The adjuster does not change braking characteristics and can be used in combination with a brake utilizing an old adjuster.

The adjuster screw will provide customers with a more secure adjuster that will offer more consistent braking performance and enhanced peace of mind while towing. This change aligns with Dexter's constant push for product innovation and providing industry leading products to its customers.

See table on next page for list of brakes and kits affected by the new adjusters.



# PRODUCT BULLETIN #413

### BRAKE ASSEMBLIES AFFECTED WITH SELF ADJUST SCREW (048-022-00) & (048-023-00):

PART NUMBER	KIT NUMBER	DESCRIPTION
023-458-00	K23-458-00	12" x 2" 6K LH Nev-R-Adjust
023-459-00	K23-459-00	12" x 2" 6K RH Nev-R-Adjust
023-464-00	K23-464-00	12" x 2" 7K LH Nev-R-Adjust
023-465-00	K23-465-00	12" x 2" 7K RH Nev-R-Adjust
023-468-00	K23-468-00	10" x 2-1/4" 3.5K LH Nev-R-Adjust
023-469-00	K23-469-00	10" x 2-1/4" 3.5K RH Nev-R-Adjust
023-476-00	K23-476-00	10" x 1-1/2" 3K LH Nev-R-Adjust
023-477-00	K23-477-00	10" x 1-1/2" 3K RH Nev-R-Adjust
023-478-00	K23-478-00	10" x 2-1/4" 4.4K LH Nev-R-Adjust New Flange
023-479-00	K23-479-00	10" x 2-1/4" 4.4K RH Nev-R-Adjust New Flange

### DEXTER'S ELECTRIC BRAKE ADJUSTER KITS NOW INCLUDE IMPROVED ADJUSTER SCREW:

KIT NUMBER	DESCRIPTION
K71-679-00	12" Electric Brake Adjuster Kit
K71-703-00	10" Electric Brake Adjuster Kit

### BRAKE ASSEMBLIES AFFECTED WITH MANUAL ADJUST SCREW (043-004-00):

PART NUMBER	KIT NUMBER	DESCRIPTION
023-026-00	K23-026-00	10" x 2-1/4" 3.5K LH
023-027-00	K23-027-00	10" x 2-1/4" 3.5K RH
023-086-00	K23-086-00	10" x 2-1/4" 3.5K LH With Parking Brake
023-087-00	K23-087-00	10" x 2-1/4" 3.5K RH With Parking Brake
023-105-00	K23-105-00	12" x 2" 6K LH 5 Hole
023-106-00	K23-106-00	12" x 2" 6K RH 5 Hole
023-105-09	N/A	12" x 2" 6K LH 9 Hole
023-106-09	N/A	12" x 2" 6K RH 9 Hole
023-112-00	K23-112-00	12" x 2" 6K LH With Parking Brake
023-113-00	K23-113-00	12" x 2" 6K RH With Parking Brake
023-180-00	K23-180-00	12" x 2" 7K LH
023-181-00	K23-181-00	12" x 2" 7K RH
023-216-00	N/A	10" x 2-1/4" 3.5K LH 47" Leads

Continues on Next Page



# PRODUCT BULLETIN #413

Continued from Previous Page

PART NUMBER	KIT NUMBER	DESCRIPTION
023-217-00	N/A	10" x 2-1/4" 3.5K RH 47" Leads
023-310-00	K23-310-00	10" x 2-1/4" 3.5K HYD LH DS
023-311-00	K23-311-00	10" x 2-1/4" 3.5K HYD RH DS
023-312-00	K23-312-00	10" x 2-1/4" 3.5K HYD LH US
023-313-00	K23-313-00	10" x 2-1/4" 3.5K HYD RH US
023-330-00	K23-330-00	10" x 2-1/4" 3.5K HYD LH US With Parking Brake
023-331-00	K23-331-00	10" x 2-1/4" 3.5K HYD RH US With Parking Brake
023-344-00	K23-344-00	10" x 2-1/4" 3.5K HYD LH Free Backing
023-345-00	K23-345-00	10" x 2-1/4" 3.5K HYD RH Free Backing
023-357-00	N/A	12" x 2" 6K LH 33" Leads
023-358-00	N/A	12" x 2" 6K RH 33" Leads
023-359-00	N/A	12" x 2" 7K LH 48" Leads
023-360-00	N/A	12" x 2" 7K RH 48" Leads
023-400-00	K23-400-00	10" x 2-1/4" 3.5K HYD LH DS with Parking Brake
023-401-00	K23-401-00	10" x 2-1/4" 3.5K HYD RH DS with Parking Brake
023-454-00	K23-454-00	10" x 2-1/4" 4.4K LH Old Style Flange
023-455-00	K23-455-00	10" x 2-1/4" 4.4K RH Old Style Flange
023-462-00	K23-462-00	10" x 2-1/4" 4.4K LH New Flange
023-463-00	K23-463-00	10" x 2-1/4" 4.4K RH New Flange
023-472-00	K23-472-00	10" x 1-1/2" 3K LH
023-473-00	K23-473-00	10" x 1-1/2" 3K RH

Please contact your Dexter account manager for additional information and further assistance.

Mark Nave  
Market Manager